

INSTALLATION GUIDE





Please Help Us Improve This Manual

We would be very interested to hear any comments you might have on this new installation manual. We are particularly interested in learning of omissions or subjects that are unclear. Please call, fax, or e-mail and direct your comments to Technical Service. Thank you very much for your assistance.

Phone: (410) 799-4200

Fax: (410) 799-4207

E-Mail: TateInfo@Tateaccessfloors.com

TABLE OF CONTENTS

1. Overview..... 3
2. Safety and Quality Assurance.... 4
3. Cautions and Warnings..... 4
4. Components 5
5. Assembly 5
6. Additional Information 7

1. Overview

The Tate RackShield IT Rack Isolation unit is the easiest way to isolate cold supply air supplied to a rack or a row of racks. It can also be used to change the intake of AC units.

Over the long-term the RackShield IT Rack Isolation unit will also reduce “total costs of ownership” by making it easier to separate cold supply and hot return airflow. High-grade aluminum track and fire resistant clear panels on durable smooth rolling casters ensure a long lasting IT Rack Isolation unit.

The RackShield can be built three lengths (24”, 48”, and 72”) depending on the number of racks in isolation.

2. Safety and Quality Assurance

The following recommendations should be carefully observed as part of any RackShield IT Rack Isolation unit installation. In particular, the safety of the installers must be placed ahead of all other considerations. Some of the following warnings or cautions have been highlighted in the appropriate sections of the manual.

- DO read this Installation Guide thoroughly prior to beginning any work.
- DO NOT attempt to lift RackShield; it may weight over 100lbs.

3. Cautions and Warnings

This manual contains important information of the installation of your RackShield IT Rack Isolation unit. We strongly recommend that you read and follow the instructions contained in this manual.

At several points in the manual there may be items of special interest or significant impact which are highlighted by one of the following notices.

Warning:

Hazards or unsafe practices that could cause personal injury or death.



Caution:

Hazards or unsafe practices that could cause product damage.



Note:

Significant points of interest.

4. Components

The major components for the RackShield are:

- RackShield IT Rack Isolation unit, fully assembled and crated.

Note:

Please refer to the ContainAire Application Guide for additional information and to determine proper product selections.

5. Assembly

Estimated Time Requirement for Unpacking/Assembly/Installation

The experienced installer of the Rack Shield should plan on approximately 1 work hours for unpacking, assembly and installation. A single individual is required for installation. Inexperienced installers should double the above time estimate.

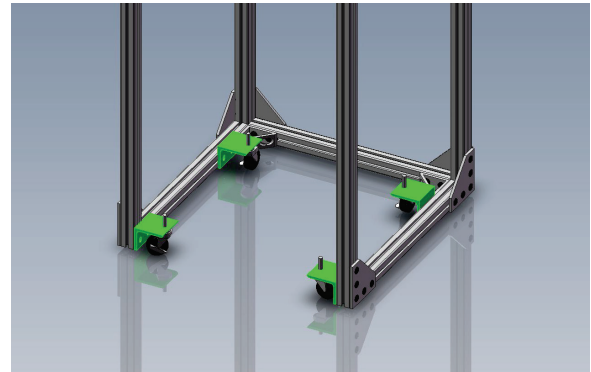

Figure 1: Rack Shield rolling wheel system

1. Determine where the Isolation is required.
2. Roll the RackShield up to the area of isolation

Ensure that the RackShield fully covers the area of isolation without allowing the mixture of hot and cold air.

Caution:

The RackShield can weigh over 100 lbs. do not lift. Tilt up and roll on wheels.

Always use the handles to move the RackShield





R1 2/14/2011

RackShield™ IT Rack Isolation

RS24XX80

6. Additional Information



Figure 2: RackShield Handles

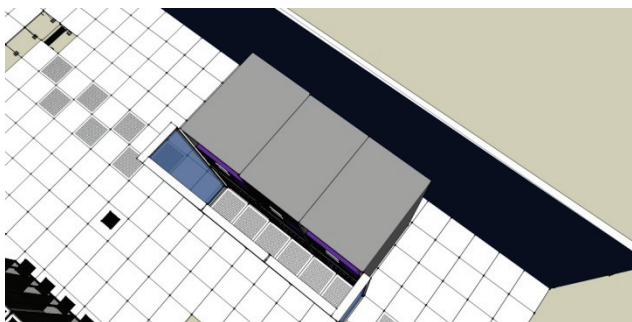
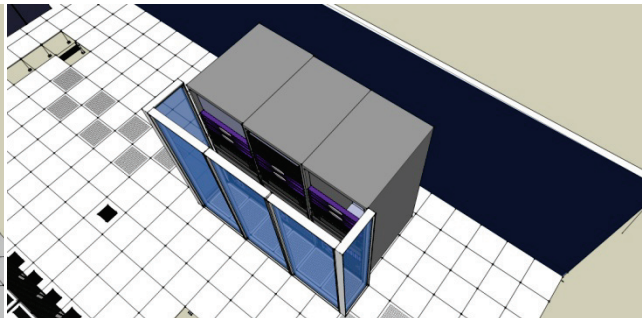
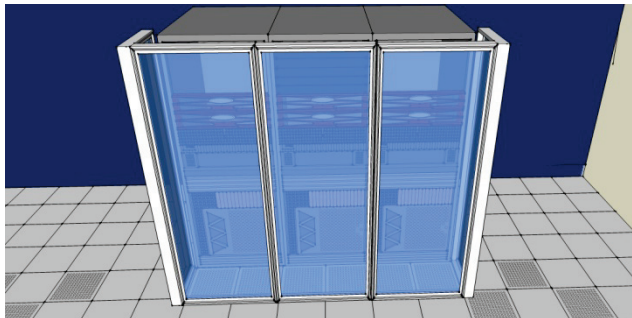

Figure 3-6: View of 72" wide RackShield installation